

BEABA

Instructions

Notice d'utilisation
Folleto de Instrucciones
Instruções de utilização

**PATENTED
PRODUCT**
système breveté



BABYCOOK™

IMPORTANT SAFEGUARDS

When using electrical appliances, basic safety precautions should always be followed including the following :

1. Read all instructions.
2. Do not touch hot surfaces. Use handles or knobs.
3. To protect against electric shock do not immerse cord, plugs or appliance in water or other liquid.
4. Close supervision is necessary when any appliance is used by or near children.
5. Unplug from outlet when not in use and before cleaning. Allow to cool before putting on or taking off parts.
6. Do not operate any appliance with a damaged cord or plug or after the appliance malfunctions or has been damaged in any manner. Return appliance to the nearest authorized service facility for examination, repair or adjustment.
7. The use of accessory attachments not recommended by the appliance manufacturer may cause injuries.
8. Do not use outdoors.
9. Do not let cord hang over edge of table or counter, or touch hot surfaces.
10. Do not place on or near hot gas or electric burner, or in a heated oven.
11. Extreme caution must be used when moving an appliance containing hot oil or other hot liquids.
12. Do not use appliance for other than intended use.
13. Before serving be sure food is at safe temperature.
14. Before serving, unplug cord from wall outlet and dish. Do not leave cord within child's reach.
15. Avoid contacting moving parts
16. Double-Blade Knife is sharp. Handle carefully. Handle blade with hand away from cutting edge when replacing or removing knife blade
17. Bowl must be taken out from the base for replacing knife blade. To reduce the risk of injury, never place cutter-assembly blades on base without bowl properly attached.
18. The appliance is intended for processing small quantities of food for immediate consumption; and is especially recommended for preparing baby food. The appliance is not intended to prepare large quantities of food at one time

Save these instructions.

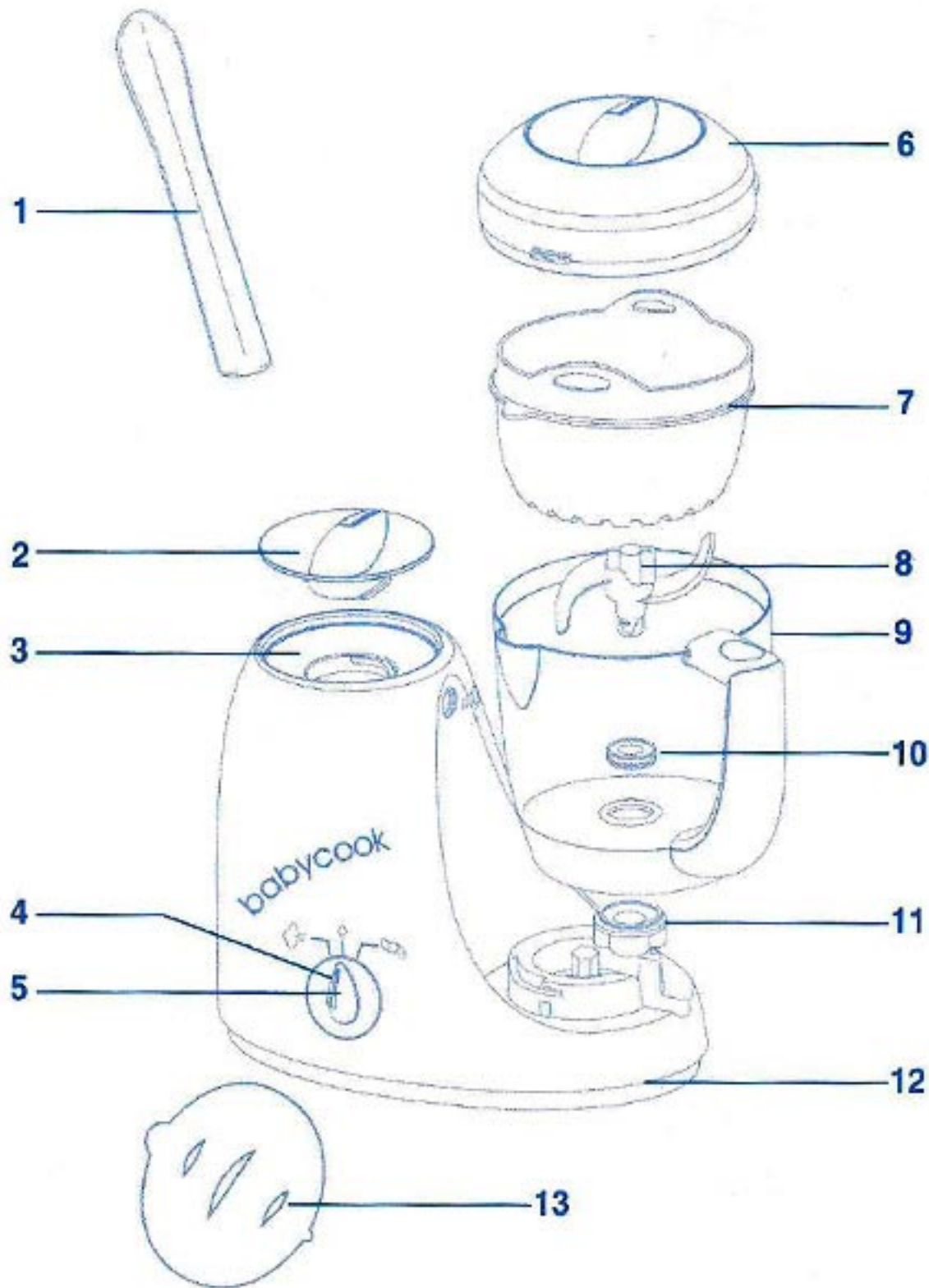

1. Spatula

2. Heating compartment lid

3. Steam heating compartment

4. Food processor controls:

⇒ cooking, reheating, defrosting

⇒ blending

5. Cooking light

6. Bowl lid: security locking system

7. Cooking, reheating, defrosting basket

8. Removable food processor blades:

easy to clean

9. Blending bowl

10. Gasket

11. Bolt for detaching blades

12. Base

13. Mixing lid



We thank and congratulate you on your choice - you have purchased an appliance that has unique performance features.

BABYCOOK has been specifically designed to prepare healthy meals for your baby, simply and rapidly. BABYCOOK cooks, reheats and defrosts food by steaming, which locks in the vitamins and ensures they are thoroughly blended."

HOW TO USE

- The appliance consists of a technical unit that incorporates a lidded heating reservoir, a removable food preparation bowl that takes the cook basket insert, the blending blade, the mixing lid and lid.
- To lock the heating unit turn it clockwise ☺.
- The preparation bowl lid locks by turning it counter clockwise ☺.
- After heating, the basket should be removed from the Blending Bowl using the spatula slotted through the basket handles.
- Care should always be taken when handling the cutter (very sharp blades) and also when taking hold of the bowl and its accessories after cooking, the residual condensed water is very hot at the end of cooking time.
- **When the appliance is brand new, it is harder to lock the bowl, make sure you latch the bowl by turning it counter clockwise until you hear it "CLICK", the appliance is then fully engaged.**

If the bowl is not fully engaged, the safety device on the appliance lid will prevent it from working.

- This appliance has a polarized plug. To reduce the risk of electric shock, this plug is intended to fit into a polarized outlet only one way. If the plug does not fit fully into the outlet, reverse the plug. If it is still does not fit, contact a qualified electrician. Do not attempt to modify the plug in any way.
- A short power supply cord is provided to reduce the risk resulting from becoming entangled in or tripping over a longer cord.
- Longer extension cords are available and may be used if care is exercised in their use.
- If an extension cord is used,
 - 1) The marked electrical rating of the extension cord should be at least as great as the electrical rating of the appliance and
 - 2) The longer cord should be arranged so that it will not drape over the countertop or table top where it can be pulled on by children or tripped over unintentionally.





WARNING

Never immerse
the electrical unit in water.

Plug the BABYCOOK into a 120 V
grounded socket

COOKING

The lower part of the bowl is marked with a 1-3 measuring scale. These mark lines are for measuring how much water to pour into the heating reservoir and set the cooking time. (Refer to the cooking guide, page No.11)

- Pour the right amount of water into the cooking bowl (using the mark lines).
- Pour the water into the heating reservoir and lock the reservoir lid.
- Place the basket with its content of diced food in the bowl making sure that the basket tab lines up with the large pouring lip of the bowl, lock the cover tightly onto the bowl, then lock the whole unit onto the pedestal.
- Plug the appliance and turn the button to the left towards the steam symbol .
- When the cooking indicator light goes out, unlock the bowl lid by turning its knob. Lift out the basket using the spatula and pour the contents into the bowl. Depending on the recipe you will either pour away or keep part of the cooking liquid.
- Only room temperature water should be put into the heating reservoir.

BLENDING

- Place the mixing lid on the jug horizontally and ensure that it is lying on the pins inside the blending bol so that it does not slip down when mixing.
- Lock the lid tightly onto the bowl, then lock the whole unit onto the pedestal.
- Plug the appliance and turn the button to the right towards the blender symbol , until you get the right consistency (pulse action normally lasts 10 seconds).

REHEATING

- Food that needs to be reheated should be placed inside a heat resistant jar and placed uncover in the cooking basket.
- Pour in 1 measure of water then proceed as for the cooking cycle.
- When the indicator light goes out, lift out the jar using a cloth, (warning – any water left over at the end of the cooking time is very hot) then mix the contents so that the temperature is even.

DEFROSTING

- Follow the same method as for reheating, but pour in 2 measures of water instead of 1, and proceed with cooking and mixing as explained earlier.

NOTE : Naturally it is best to use very fresh fruit and vegetables because they offer the highest vitamin content, but of course you can use your BABYCOOK to cook deep-frozen fruit and vegetables that have been defrosted either directly in the BABYCOOK or in the refrigerator (never defrost food at room temperature).

OFF

- Turn the button back to the 0 symbol every time after use.

COOKING GUIDE

These doses are given purely as an example and may vary.

Food	Measures of water			
	1	2	3	
Vegetables Potatoes	For reheating		•	
		Carrots*		•
		Turnips*		•
		Runner beans	•	
		Courgettes	•	
		Leeks		•
		Peas		•
		Pumpkin		•
		Cauliflower		•
		Meat Red		
Poultry			•	
Fish			•	
Fruit Apples		•		
	Pears	•		
	Strawberries	•		
	Mandarin oranges	•		
	Pineapple			•
Cooking time	approx. 7 minutes	approx. 10 minutes	approx. 15 minutes	

* All food should be diced.

CLEANING

- Always unplug the appliance before you start cleaning it.
- Immediately rinse the accessories that have come into contact with the food under running water to prevent germs forming.
- **Descal the heating reservoir from time to time with white vinegar (distilled).** **Never use a chemical descaler or a descaler for coffee machines in the reservoir.** Pour 3 measures of vinegar, spirit vinegar, into the heating reservoir. Run one cooking cycle then rinse carefully. Then run two heating cycles with plain water only (3 measures) in the reservoir to rinse it properly.
- After you have cleaned the blade, make sure that the gasket is properly put back in place.

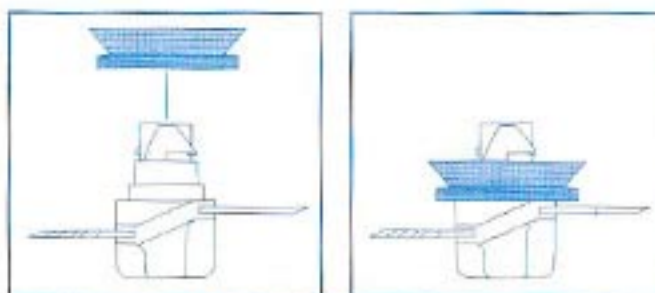

Placing the gasket on the blender cutter

- Babycook accessories are not suited to sterilisation.

RECOMMENDATIONS

- Never put the bowl on the pedestal without the blender cutter in place
- Do not move the appliance or put a cover over it while in use.
- Never immerse the electrical pedestal unit in water.
- Keep the BABYCOOK out of children's reach and always lock the bowl lid fully so that the blade is inaccessible.
- Use the BABYCOOK on a flat surface.
- Plug the BABYCOOK into a 120 V grounded socket.
- Do not run the BABYCOOK in cooking mode when the reservoir is dry.
- Do not fill the bowl above the mark lines.
- Regularly check that the steam outlet hole on the bowl is not blocked. Do not add water to the bleeding bowl before mixing. There is a risk of very hot liquid being splashed when mixing.
- Never lean over the steam outlet hole during the cooking cycle (risk of scalding).
- Handle hot parts with great care.
- **Regularly de-scale the heating reservoir**
- If you need to make a claim, please quote the serial number printed on the label located on the underside of the Babycook heating pedestal.
- Any handling of the device must be carried out under the responsibility of an authorized person.
- Turn the on/off switch to 0 after each steaming cycle.

- The mixing blade must always be placed in the bleeding bowl in cooking mode and mixing mode.
- Never unlock the bleeding bowl from its base before the cooking light has been switched off and before the device has cooled completely.
- Never open the bleeding bowl lid before the device has cooled.
- Use only water or white vinegar (for descaling) in the heating reservoir. Never put food, salt or any other non-recommended elements in the heating reservoir.
- Never leave water in the reservoir. Empty any leftover water after each use.

TECHNICAL DATA

Voltage : 120 V ~ / 50-60 Hz

Rating : 350 W (motor 130 W)

GUARANTEE

Beaba guarantees the Babycook™ for one year from the date of purchase of the product on presentation of proof of purchase. Always remember to keep a copy of your proof of purchase displaying the date of purchase in order to benefit from Beaba's guarantee service.

Beaba guarantees any fault in compliance provided that the fault observed is not the result of abnormal use of the product, or of its having been dropped, and provided that the other conditions have been respected (in particular, proof of purchase).

For any queries about the Babycook™, please use the following procedures:

- Electrical problem or problem with the product's functioning (product under guarantee): contact the retailer where you bought the product or go to www.beaba.com or www.beaba.us
- Spare parts or exchange parts (product under guarantee or not under guarantee): go to www.euro-baby.us or contact us:

Euro Baby

1140 McDermott Drive

West Chester, PA 19380

1-877-844-9575